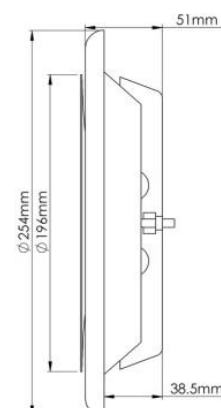
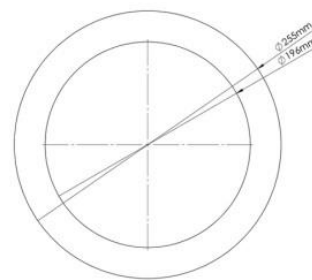
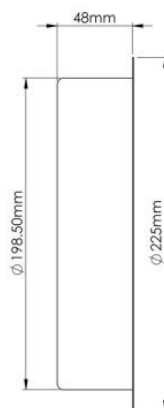

# PRODUCT DATA SHEET

## MW205

### WHITE METAL CEILING AIR SUPPLY VALVE

**W** RAL9010

## SPECIFICATION DETAILS

The MW205 200mm diameter Round White Metal Ceiling Air Supply Valve is manufactured from White Epoxy Powder Coated Steel. The valve has a male spigot to fit inside 200mm Round Duct.

The MW205 supply air valve is fully adjustable and has a locking nut to fix the position of the control disc upon commissioning.

The MW205 is supplied complete with a fixing body with pre-drilled holes for installation.

MW205 has been designed for use with 200mm Round Ducting.

### MAX/MIN OPERATING TEMPERATURES

+ 60°C to - 15°C

### Manufacturer:

Verplas Ltd

### Part Number:

MW205

### Size:

200mm Diameter

### For use with:

200mm Ducting

### Box quantity:

7

### Individual Weight:

710g

### Colour:

White

## PERFORMANCE CURVE

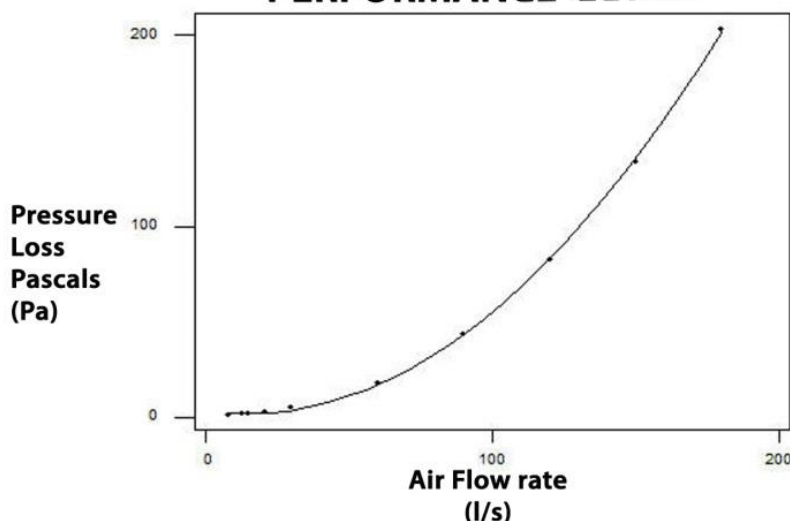

\*Pressure losses with Control Disk 10mm open

## Associated Ancillaries

200mm Round Ceiling Vent Diffuser



VKC370F

200mm to 150mm Round Reducer



VKC436

200mm Stainless Steel Ceiling Valve



SS204

200mm White Metal Ceiling Extract Valve



MW204

200mm Fire Rated Extract Valve



MW204FRE

### AIRFLOW

### RESISTANCE

8 l/s

1.90 pa

13 l/s

2.80 pa

21 l/s

4.80 pa

30 l/s

8.30 pa

60 l/s

29.00 pa

120 l/s

134.00 pa